

Primer B1 & B2

A functional range of essential ancillary products which contribute to the successful application of GCP waterproofing systems.

Product Description

Primer B1 & B2 are one part solvent borne bituminous primer and should be used to condition concrete and other surfaces to promote the adhesion of Bituthene self-adhesive membranes. They should also be used to prime sealant chases prior to sealing with Bituthene Mastic.

Features

- Primer B1 & B2
- Provides a tack coat - promotes bonding of BITUTHENE® and bituminous sealants to horizontal and vertical surfaces.
- Good coverage - 6 to 8 sq m per litre depending on surface porosity.
- Easily applied - by brush or roller
- Moisture tolerant primer system - Primer B2 allows application in damp or marginal weather conditions.

Applications

Primer B1 & Primer B2 have been designed to complete the range of Grace waterproofing systems.

When using Bituthene membranes it is essential to have a comprehensive range of ancillary materials which contribute to the watertightness of the overall membrane system. These supplementary materials assist with the application by solving small detailing problems and provide the vital elements which complement the system.

Supply

Primer B1	18.2 litre pails Coverage 6-8 sq meter perlitre depending on method of application, surface texture, porosity and ambient temperatre
Primer B2	25 litre pail 8-10m2 / litre coverage
(Damp Surface) Storage	Dry conditions below +25°C

Equipment by Others

Soft brush or natural fibre roller for applying Primer, stiff broom and airline for cleaning surfaces.

Specification

Primer B1 & Primer B2 shall be applied strictly in accordance with the manufacturer's instructions and supplied by GCP Applied Technologies. For further information contact your local GCP representative. Health and Safety Refer to relevant Material Safety Data Sheets.

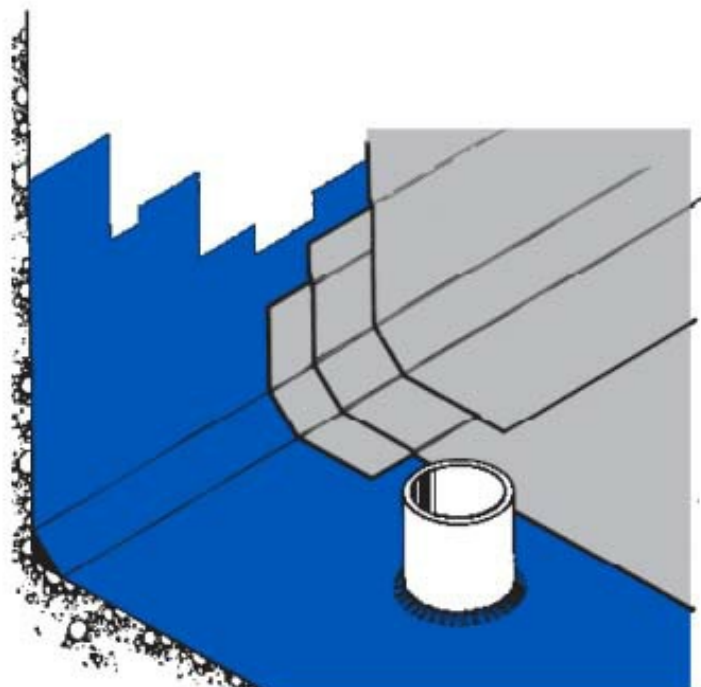

Installation

Do not use below -5°C . At air temperatures between -5°C and $+4^{\circ}\text{C}$ measures should be taken to ensure that surfaces are free from ice, frost or condensation.

Surfaces should be dry, flat, free of sharp protrusions and hollows. Use a stiff broom and airline to remove dust and all contaminants.

A single coat of Primer should be applied by brush or roller, brushing/ rolling out well to give a thin even coat. The Primer must not be poured on to surfaces and care should be taken to avoid ponding in depressions. Allow a minimum drying period of 1 hour ensuring primer is completely dry before receiving membranes or bituminous sealants. For priming large areas a roller will prove most effective. Clean tools and equipment with mineral spirits.

Technical Services

For assistance with working drawings for projects and additional technical advice, please contact GCP Applied Technologies.

Health and Safety

Refer to relevant Material Safety Data Sheets.

gcpat.in | India customer service: +91 124 4885900

We hope the information here will be helpful. It is based on data and knowledge considered to be true and accurate, and is offered for consideration, investigation and verification by the user, but we do not warrant the results to be obtained. Please read all statements, recommendations, and suggestions in conjunction with our conditions of sale, which apply to all goods supplied by us. No statement, recommendation, or suggestion is intended for any use that would infringe any patent, copyright, or other third party right.

Bituthene is a trademark, which may be registered in the United States and/or other countries, of GCP Applied Technologies, Inc. This trademark list has been compiled using available published information as of the publication date and may not accurately reflect current trademark ownership or status.

© Copyright 2016 GCP Applied Technologies, Inc. All rights reserved

GCP Applied Technologies Inc., 2325 Lakeview Parkway, Alpharetta, GA 30009, USA

GCP Applied Technologies India Private Limited, Unit No. 208, Second Floor, Time Tower Building, Sector-28, MG Road, Gurugram, Haryana-122002, India

This document is only current as of the last updated date stated below and is valid only for use in India. It is important that you always refer to the currently available information at the URL below to provide the most current product information at the time of use. Additional literature such as Contractor Manuals, Technical Bulletins, Detail Drawings and detailing recommendations and other relevant documents are also available on www.gcpat.in. Information found on other websites must not be relied upon, as they may not be up-to-date or applicable to the conditions in your location and we do not accept any responsibility for their content. If there are any conflicts or if you need more information, please contact GCP Customer Service.

Last Updated: 2022-11-18

gcpat.in/solutions/products/primer-b1-b2